

## Ground Floor

Lounge	5000mm x 3350mm	16'5" x 11'0"
Dining/Family	3050mm x 5000mm	10'0" x 16'5"
Kitchen	3350mm x 3050mm	11'0" x 10'0"
Cloaks	1800mm x 900mm	5'11" x 2'11"

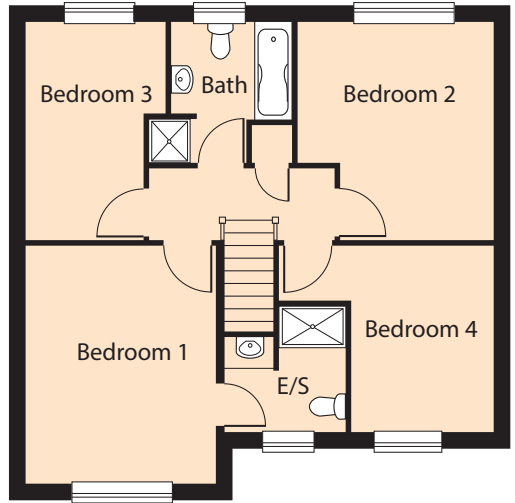

## Upper Floor

Bed 1	4200mm x 3350mm	13'9" x 11'0"
En Suite	2200mm x 2300mm	7'3" x 7'6"
Bed 2	3900mm x 3500mm	12'9" x 11'6"
Bed 3	3850mm x 2500mm	12'7" x 8'2"
Bed 4	3250mm x 3800mm	10'8" x 12'6"
Bathroom	2450mm x 2150mm	8'0" x 7'1"